

# Christchurch Baptist Church

## PROPOSED: Ground Floor Model

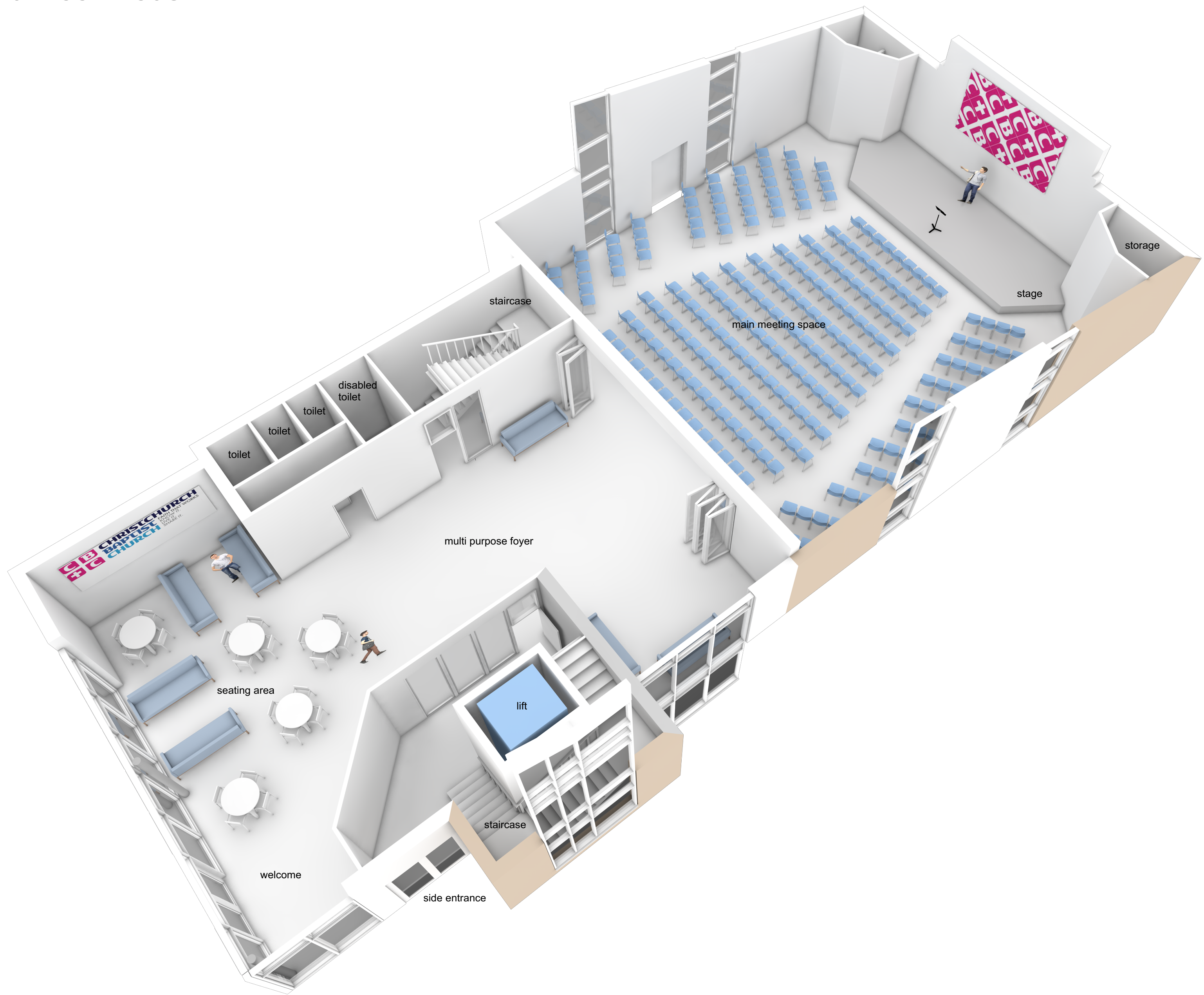

A	25.10.2019	Revisions following meeting with Building Committee 22.10.2019
B	18.11.2019	Revisions following meeting with Building Committee 12.11.2019
C	20.11.2019	Revisions following meeting with Building Committee 19.11.2019
D	28.11.2019	Renumbered. Presentation to Church Meeting
E	11.02.2020	Revised prior to Planning Application

No:	Date:	Revision:			
Project Christchurch Baptist Church 51 Bargates Christchurch BH23 1QE		Drawing Model: Ground Floor Plan	Date 21.10.2019	Scale on A2 n/a	Dwg No 1640.41E
			All dimensions to be checked not scaled   Ensure this is the current relevant drawing		
			© 2018 DUA Architecture - All Rights Reserved		
		8 Brearley House 278 Lymington Road Christchurch Dorset BH23 5ET 01425 278 252 architects@duastudio.com www.duastudio.com www.newforesthouses.com			