

Christchurch Baptist Church

PROPOSED: First Floor Model

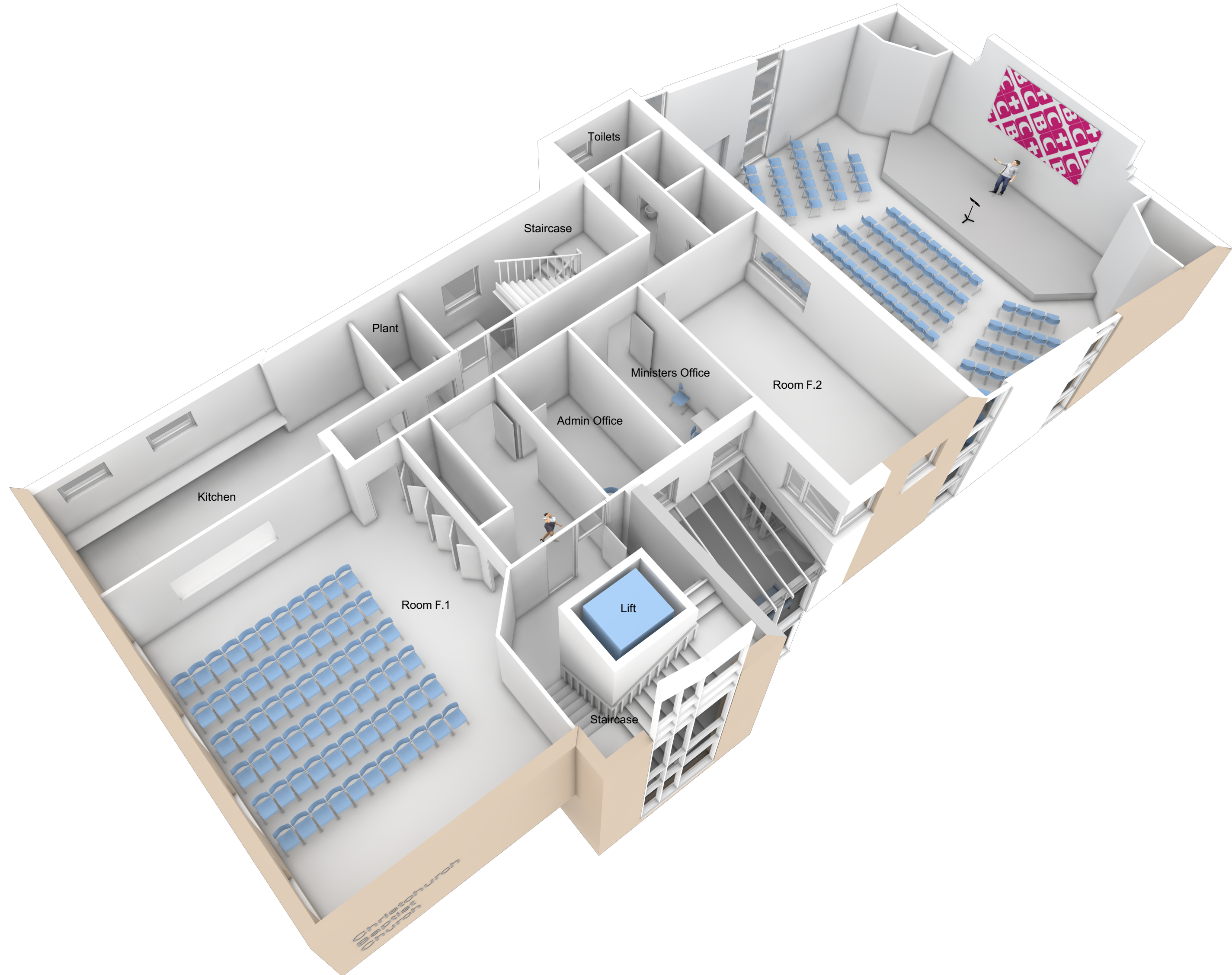

A	25.10.2019	Revisions following meeting with Building Committee	22.10.2019
B	18.11.2019	Revisions following meeting with Building Committee	12.11.2019
C	20.11.2019	Revisions following meeting with Building Committee	19.11.2019
D	28.11.2019	Renumbered. Presentation to Church Meeting	
E	11.02.2020	Revised prior to Planning Application	

No:	Date:	Revision:		
Project Christchurch Baptist Church 51 Bargates Christchurch BH23 1QE	Drawing Model: First Floor Plan	Date 21.10.2019	Scale on A2 n/a	Dwg No 1640.42E
<small>All dimensions to be checked not scaled Ensure this is the current relevant drawing</small>				
<small>© 2018 DUA Architecture - All Rights Reserved</small>				
		8 Brearley House 278 Lymington Road Christchurch Dorset BH23 5ET 01425 278 252 architects@duastudio.com		
		www.duastudio.com www.newforeshouses.com		